

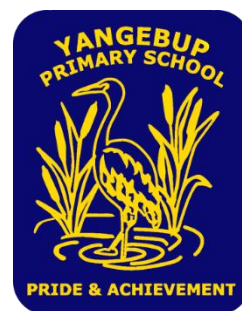

Department of
Education



Yangebup Primary School Parent Handbook 2026



Our vision is to promote a respectful environment that gives students a sense of belonging, the safety to take risks and the opportunities to achieve continuous growth in their learning journey.

Principal's Message

Yangebup Primary School is located in the heart of the Beeliar wetlands. This beautiful location means that from time to time, we are visited by unique wetland birds, and we try to reflect this natural environment in our school with plenty of trees and native plants. Our school boasts spacious classrooms as well as varied play areas including a sensory garden. We are a relatively small school, and this allows us to foster a strong sense of community and belonging.

Yangebup Primary School opened in 1982 and caters for students from Kindergarten to Year 6. The school population consists of students from wide cultural backgrounds, providing rich and diverse opportunities for all. We offer specialised subjects in Visual Arts, Physical Education, Music, Japanese and Science from Year 1 – 6.



Every class has a structured morning to explicitly teach students basic skills to be able to read, write and understand numbers. Our programs are designed to build students' knowledge and skills from K to Year 6.

In the early years, we use a synthetic phonics approach to teach students how to read. Once students have mastered the phonetic code, they graduate to reading independent texts.

We believe that every student can learn, and every student is an essential part of our school community. Therefore we take a restorative and educative approach to behaviour and use every opportunity to teach our values and behaviour expectations.

Our staff are highly dedicated to our students, providing fun lunch time activities, breakfast club and lots of support to help them achieve their best.

The Yangebup community is highly supportive of the school. We have a pro-active and effective P&C and School Board. Parents are also welcome to become Class Parent Representatives, allowing them to meet with the principal once a term to give feedback from their classes' parents.

We are committed to our goals of giving all students a sense of belonging, the safety to take risks and the opportunities to achieve continuous growth in their learning journey. We provide a safe and supportive environment dedicated to giving children opportunities to learn, create and become responsible citizens and lifelong learners.

Andrea Macfarlane
Principal

Absences

Parents are asked to contact the school through the Compass app if their child is unable to attend. Alternatively you can contact school via phone or email.

Parents need to apply to the principal by email if they wish to go on holidays during the school term. Please see our Attendance Policy on the website for more details.

Assemblies

School assemblies are held throughout the term on a Wednesday, starting at 2.20pm, in our Undercover Area. Each class from Pre-Primary to Year 6 will host one assembly per year. *Please see the term planner for dates.*

Before and After School Care

Teddy Bear Corner OSHC Club operate a Before and After School program on our school grounds. Vacation Care is also offered. Contact: 0402 162 697

email: yangebup.teddybearcorner@inet.net.au or visit www.teddybearcorner.com.au

Bell Times

Start of Day:	8.40am
Lunch Play:	10.50am
Lunch Eating:	11.20 - 11.35am
Recess:	1.35 - 1.55pm
End of school:	2.55pm

The office opens at **8.15**, and classrooms at **8.30am**. Students may enter the school at 8.15am but will be supervised in the library every day or at Breakfast Club in the Science Room on Mondays, Wednesdays, and Fridays.

Breakfast Club

All students are welcome to come to Breakfast Club on Monday, Wednesday, and Friday at 8.15 in the Science Room.

Car Parking

Off road parking is available either by the tennis courts or Kindergarten on Osprey Drive, at the bottom of Moorhen Drive, or behind the shops on Swallow Drive.

At no stage are parents to use the Staff Carpark as this can cause a dangerous situation due to staff vehicles, delivery trucks and school buses using this carpark.

Please do not park on the verges.

Chaplain

Our School Chaplain Joel supports the school's Pastoral Care and Values programs including a School Mentoring Program.



Communication with School

Throughout the year a variety of methods will be used to communicate between students, parents, and staff. You may also request an interview with your child's teacher whenever needed. The school will communicate with you through Compass, email or phone call. The website is also a valuable source of information.

Dentist

Our School Dentist is located at South Lake Primary School on Mason Court, South Lake.
Contact number: 9417 3242.

Dress Code Requirements

Hats

Black bucket hats with reversible faction colours.

Plain black bucket hat or legionnaires cap (cap with long ear flaps) Logos are not acceptable.

Caps are not sun smart so not acceptable

Uniform

Black skorts / shorts.

Royal Blue & Black school polo shirt

Black track suit bottoms

Long sleeved black or blue shirt can be worn under polo shirt.

Suitable and safe footwear for participation in activities as directed by class teacher.

School uniform jackets and tops that comply with the school colours, not including hoodies or logos

PE and Sports Uniforms

Suitable and safe footwear for participation in activities as directed by class teacher.

Faction coloured tee shirts or polo shirts (Gold, Red, Green)

Interschool uniforms for students in Years 4-7 are provided by the school.

Faction Friday

Faction t-shirts are encouraged to be worn on Fridays and on Carnival days

No brand motifs, stripes or multicoloured patterns are to be on any part of the school uniform
Please remember to CLEARLY NAME ALL ITEMS OF CLOTHING, especially jackets and hats.

Hair

Shoulder length or longer hair, it must be tied back with a hair elastic (males & females). This is to ensure hair to hair contact is limited, thus reducing the ability of lice to spread between students.

Jewellery

To reduce occupational health and safety risks and to ensure standardisation, jewellery, (excluding ear studs, one thin chain & watches), nail polish / varnish and make-up are not to be worn.

Uniform orders

When the uniform shop is not open, orders can be placed using the online via the QR code. More details are on the P&C Facebook page.

For any queries, please email the uniform shop P&C coordinator at yangebupprimaryuniforms@gmail.com. Orders will be checked on a regular basis and delivered to the office.



eRideables and eBikes

The safety of students is our priority and under WA laws, only individuals aged 16 and over are permitted to use eRideables or eBikes with the motor engaged.

From 2 February 2026 (first day of Term 1), the Department of Education is introducing a ban on the use and storage of eRideables and eBikes on public schools grounds by students under the age of 16. This ban supports student safety and aligns with road safety laws.

Please be advised that from Term 1 2026, if a student **under 16** brings an eRideable or eBike onto the school grounds, the device will be confiscated, and parents/carers will be contacted to collect the device. Please be aware that not all eRideables or eBikes sold in WA are legal to ride on WA roads and paths.

Visit the www.wa.gov.au/organisation/road-safety-commission for more information on [eRideable](#) and [eBike](#) laws, penalties, buying guides and safety.

We encourage children to ride or scoot to school. We have a lock up shed where bikes, scooters etc can be safely stored during the school day.

Events

There are a variety of events each year organised by either the school or the P&C. Some highlights are Book Week Dress Up, NAIDOC Week, Open Night & Family Picnic, Disco and Colour Run.

Faction Teams

The school has three Factions – **Koort** (Red), **Boodjera** (Green) and **Ngangk** (Gold). Students are encouraged to wear their faction shirts to school on Fridays.

Faction shirts can be purchased from the P&C, along with reversible school/faction hats.

Homework

At Yangebup we believe homework to be worthwhile as it extends learning opportunities beyond the school environment.

Homework is a positive learning tool that develops, consolidates, and reinforces skills and understandings presented in class.

We recognise that homework can assist in developing sound work routines, organisational skills and self-discipline and should be of educational value. Completing homework is the responsibility of the home.

The purpose of homework is

- For students to practise and reinforce what has been learned in class.
- For students to develop sound study and work habits.
- For students to develop good reading habits.

Homework will not be set for children who are sick or who are going away on holiday.

Parent Responsibility

- To provide an area where the child feels comfortable.
- To monitor the time spent on homework- a routine time block considering other activities.
- To check and sign homework tasks.
- To show interest and to offer guidance but not to solve content problems.

- To notify the teacher in writing, via the communication book, if the homework could not be completed by the due date.
- Read to and listen to your child read.

Independent Public School

Yangebup Primary School was awarded Independent Public-School status in 2023, commencing in 2024. This is a recognition of our commitment to working with our school community and our ability to make significant improvements to the school in order to increase student outcomes.

Late Arrivals

If your child arrives at school after the start siren at 8.40am, they will need to collect a late slip from the office.

Mobile Phones and Smart Watches

Mobile phones and other electronic devices brought to school by students need to be handed in to the front office at the start of each day. This includes watches that connect to the internet (even if they are set on school mode) or can take photos or record. Valuables should not be brought to school and should not be left in school bags.

Optometrist and Glasses

Parents can apply to the school for financial assistance with optometrist appointments and glasses if they are having financial difficulties. We have an arrangement with Cockburn Health, so please don't hesitate to ask.

Parents and Citizens (P&C)

The P & C works positively and effectively with the school to achieve its aims. Monthly meetings are held on the first Wednesday of each month, during school terms, at 6pm in the library.

Email: yangebupbandc@gmail.com

Personal Items

Students' personal items such as toys, collectables, fidget toys, sport equipment, extra stationery etc should not be brought to school. These items can cause conflict and can be lost, stolen, or broken. The exceptions are when staff ask students to bring an item from home for a classroom project or an object is designed to assist a student and is part of their individual plan agreed on by parents and teacher.

Reports

Student reports are issued at the end of each semester. PP to Year 6 reports are posted on Compass.

School Board

With the advent of Independent Public-School status in 2024, our School Council became a School Board. New members are called for, usually in Term 4, when tenures expire.

School Nurse

The school Nurse provides screening of vision, hearing and development for all Kindy students, and/or any child commencing school for the first time in Pre-Primary and Year 1, on completion of a consent form (including children that are new to the country). The school Nurse is also available for children for whom parents and/or teachers have a concern. The school Nurse will send out consent forms early in the year.

School Parliament

The student parliament is a group of elected Year 6 students who are recognised and selected for their leadership skills. The parliament simulates the Parliament, with ministries and deputy ministries formed to carry out many responsibilities around the school, including running our whole school assemblies.

Student Early Release

Parents/guardians who wish to take their child/children out of class during the school day MUST report to the office to complete a Student Leave Pass. Once this has been authorised by a staff member it then needs to be handed to the classroom teacher.

Term Dates 2026

Semester One

- | | |
|--------|----------------------------------|
| Term 1 | Monday 2 Feb – Thursday 2 April |
| Term 2 | Tuesday 21 April – Friday 3 July |

Semester Two

- | | |
|--------|----------------------------------|
| Term 3 | Tuesday 21 July – Friday 25 Sept |
| Term 4 | Monday 12 Oct – Thursday 17 Dec |

2026 School Development Days

- | | |
|--------|--|
| Term 1 | -- |
| Term 2 | Monday 20 April |
| Term 3 | Monday 20 July |
| Term 4 | Friday 6 November , Friday 18 December |

2026 Public Holidays

Monday **2 March** – Labour Day
Friday **3 April** – Good Friday
Friday **27 April** – Anzac Day
Monday **1 June** – WA Day

2026 TERM CALENDAR

TERM ONE (2 Feb – 2 April)

WEEK	MON	TUES	WED	THURS	FRI
1	2 Feb	3	4	5	6
2	9	10	11	12	13
3	16	17	18	19	20
4	23	24	25	26	27
5	2 Mar	3	4	5	6
6	9	10	11	12	13
7	16	17	18	19	20
8	23	24	25	26	27
9	30	31	1 Apr	2	3

TERM TWO (21 April – 3 July)

WEEK	MON	TUES	WED	THURS	FRI
1	20	21	22	23	24
2	27	28	29	30	1 May
3	4	5	6	7	8
4	11	12	13	14	15
5	18	19	20	21	22
6	25	26	27	28	29
7	1 June	2	3	4	5
8	8	9	10	11	12
9	15	16	17	18	19
10	22	23	24	25	26
11	29	30	1 July	2	3

TERM THREE (21 July – 25 Sept)

WEEK	MON	TUES	WED	THURS	FRI
1	20	21	22	23	24
2	27	28	29	30	31
3	3 Aug	4	5	6	7
4	10	11	12	13	14
5	17	18	19	20	21
6	24	25	26	27	28
7	31	1 Sep	2	3	4
8	7	8	9	10	11
9	14	15	16	17	18
10	21	22	23	24	25

TERM FOUR (12 Oct – 17 Dec)

WEEK	MON	TUES	WED	THURS	FRI
1	12 Oct	13	14	15	16
2	19	20	21	22	23
3	26	27	28	29	30
4	2 Nov	3	4	5	6
5	9	10	11	12	13
6	16	17	18	19	20
7	23	24	25	26	27
8	30	1 Dec	2	3	4
9	7	8	9	10	11
10	14	15	16	17	18

School Development Days

Public Holidays

2025 School Development Days

Term 1 --
 Term 2 Monday **20 April**
 Term 3 Monday **20 July**
 Term 4 Friday **6 November**, Friday **18 December**

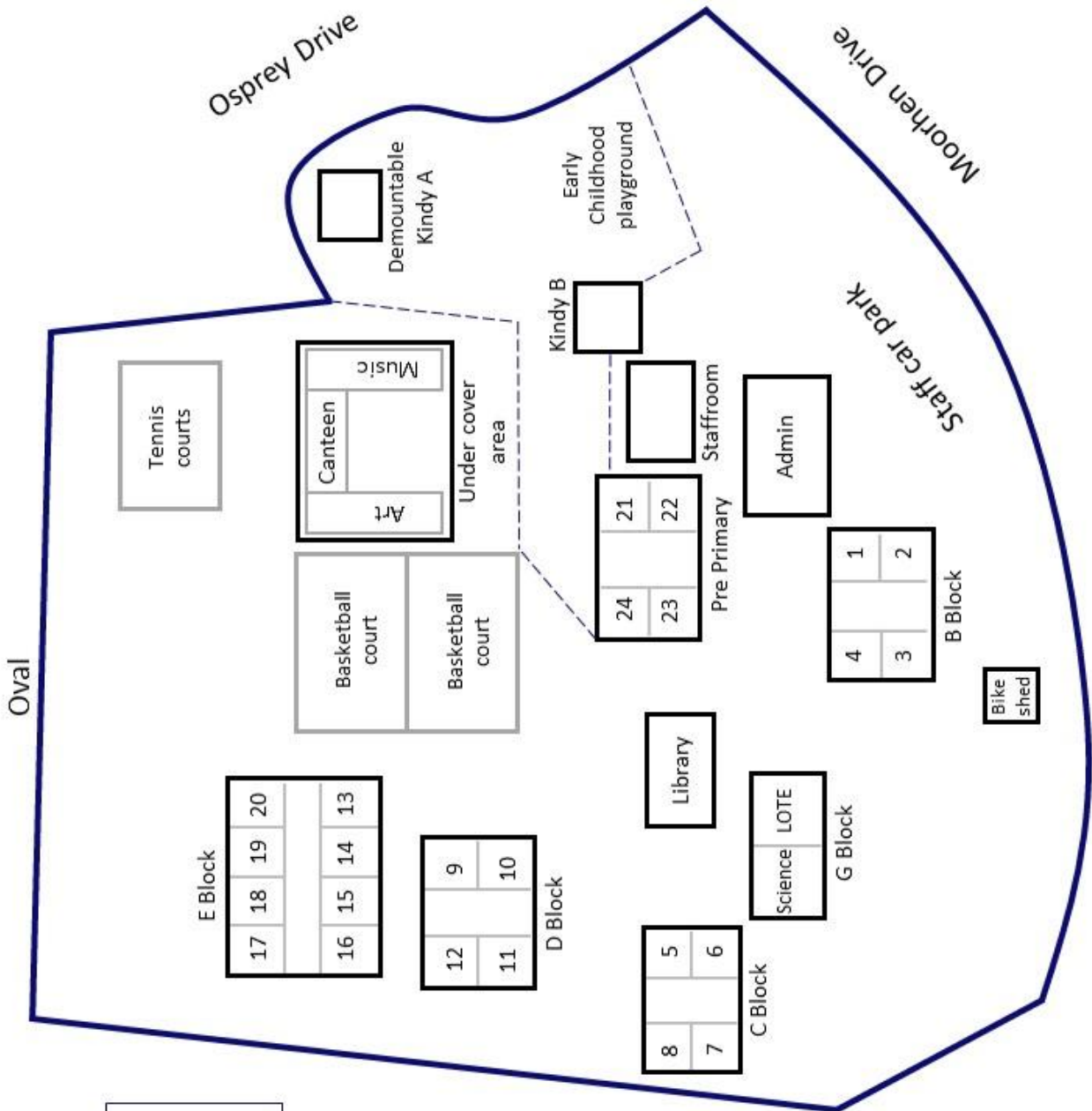

16	Maths Room
17	Teddy Bear Corner
20	Sensory Room
21	Reading Room

shops